

## Certification of Analysis

- ▶ **ITEM**            70D/5F, SPANDEX
- ▶ **LUSTER**        Semi Dull
- ▶ **LOT**             D7230A
- ▶ **PHYSICAL PROPERTIES**

Classification	Unit	Specification	Test Result
Denier	g/9000m	70.0±2.8	70.1
Tenacity	g/d	0.9↑	1.2
Elongation at break	%	484.2 ↑	544.8
Oil Pick-up	%	3.0±2.0	3.0
Package Relaxation	%	4.0±3.0	5.4
Modulus (SS200%)	g	9.5±1.5	9.3

▶ **PACKAGE SIZE**

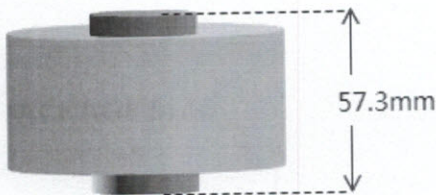

▶ **BOX SIZE**

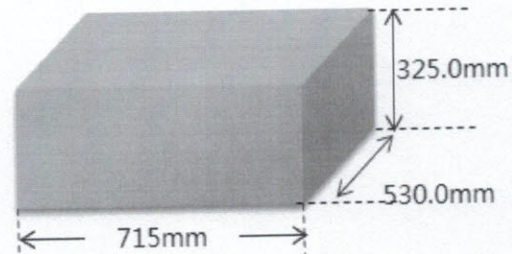

**33.0Kg/box ( 0.55Kg/cheese × 60 cheeses/box )**

▶ **CAUTION**

- ① Please store the spandex at ambient temperature and do not expose to direct sunlight. Open the box and pre-condition the spandex by exposing them to the production environment for a minimum of 24h.
- ② Do not use spandex from different batches in mixture.
- ③ Please do not use spandex with different package size in mixture.
- ④ Suggest using spandex with similar production dates together.
- ⑤ If it is the first time to use our spandex, please start a trial firstly to guarantee the manufacturing process and the fabric is approved.

**Any question with regards to above mentioned data can be informed to the Quality Control DEPT directly**



## Certification of Analysis

- ▶ **ITEM** 40D/3F, SPANDEX
- ▶ **LUSTER** Semi Dull
- ▶ **LOT** CQ600/C4290G
- ▶ **PHYSICAL PROPERTIES**

Classification	Unit	Specification	Test Result
Denier	d/9000m	40.0±1.6	40.1
Tenacity	g/d	1.0↑	1.3
Elongation at break	%	485.1↑	530.1
Oil Pick-up	%	3.5±2.0	3.5
Package Relaxation	%	14.0±3.0	13.9
Modulus (SS200%)	g	6.6±1.2	6.8

▶ **PACKAGE SIZE**

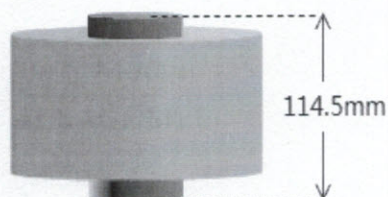

▶ **BOX SIZE**

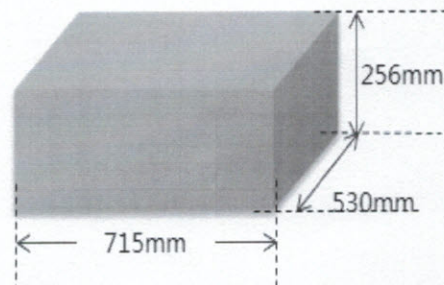

30.9Kg/box ( 0.644Kg/cheese × 48 cheeses/box )

▶ **CAUTION**

- ① Please store the spandex at ambient temperature and do not expose to direct sunlight. Open the box and pre-condition the spandex by exposing them to the production environment for a minimum of 24h.
- ② Do not use spandex from different batches in mixture.
- ③ Please do not use spandex with different package size in mixture.
- ④ Suggest using spandex with similar production dates together.
- ⑤ If it is the first time to use our spandex, please start a trial firstly to guarantee the manufacturing process and the fabric is approved.

**Any question with regards to above mentioned data can be informed to the Quality Control DEPT directly**

